

Chronograph Models

Description of the display and control buttons

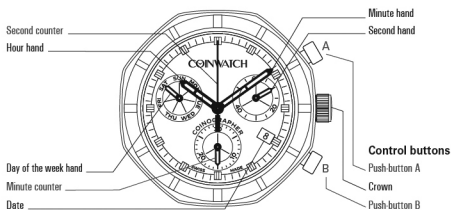

01

Chronograph: Basic function

(Start / Stop / Reset)

Example:

- 1 Start: Press Push-button A.
- 2 Stop: to stop the timing, press Push-button A once more and read the chronograph counters: 20 min / 38 sec
- 3 Zero positioning: Press Push-button B. (The chronograph hands will be reset to their zero positions.)

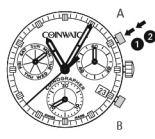

05

Setting the time

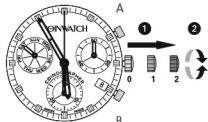

- 1 Pull out the crown to Position 2, all hands will stop.
- 2 Turn the crown clockwise (forward) or counterclockwise (backward) to set the time. The date will advance automatically at midnight.
- 3 Push the crown back to Position 0.

Please note:

* In order to set the time to the exact second, 1 must be pulled out when the second hand is in position «6». Once the hour and minute hands have been set, 2 must be pushed back into Position 0 at the exact second.

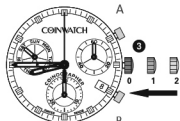

02

Chronograph: Accumulated timing

Example:

- 1 Start: (start timing)
- 2 Stop: (e.g. 15 min 5 sec following 1)
- 3 Restart: (timing is resumed)
- 4 * Stop: (e.g. 5 min 12 sec following 3) = 20 min 17 sec
(The accumulated measured time is shown)
- 5 Reset: The chronograph hands are returned to their zero positions.

Please note:

* Following 4, the accumulation of the timing can be continued by pressing Push-button A (Restart / Stop, Restart / Stop, ...).

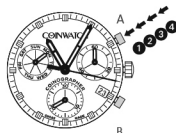

06

Setting the date (quick mode)

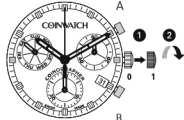

- 1 Pull out the crown to Position 1 (the watch continues to run).
- 2 Turn the crown counterclockwise (backward) until the correct date appears.
- 3 Push the crown back to Position 0.

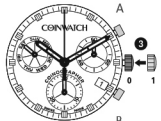

Important note:

Do not make any adjustments when your watch shows a time between 8:00 p.m. to 4:00 a.m. During this time slot, several complex operations take place and any outside interference may damage the movement.

03

Chronograph: Intermediate or interval timing

Example:

- 1 Start: (start timing)
- 2 Display interval: e.g. 20 minutes 17 seconds (timing continues in the background)
- 3 Making up the measured time: (the chronograph hands are quickly advanced to the ongoing measured time)
- 4 Stop: (Final time is displayed.)
- 5 Reset: The chronograph hands are returned to their zero position

Please note:

* Following 3, further intervals or intermediates can be displayed by pressing Push-button B (display interval / make up measured time, ...).

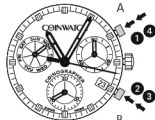

07

Setting the date, day of the week and time

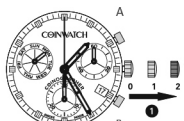

Example:

- Date / time on the watch: 17 / 01:25 / MON

- Present date / time: 23 / 20:35 / THU

- 1 Pull out the crown to Position 2 (the watch stops).
- 2 Turn the crown counterclockwise (backward) until yesterday's day of the week WED appears.
- 3 Push the crown to Position 1.
- 4 Turn the crown until yesterday's date appears 22.
- 5 Pull out the crown to Position 2 (the watch stops).
- 6 Turn the crown counterclockwise (backward) until the correct date 23 and day of the week THU appears.
- 7 ** Continue to turn the crown counterclockwise (backward) until the correct time 8:35 p.m. appears.
- 8 Push the crown back into Position 0.

Please note:

* To set your watch to the exact second, please refer to the chapter entitled «Setting the Times».

** Please observe the a.m./p.m. clock rhythm.

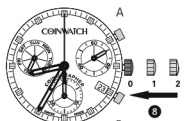
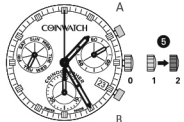
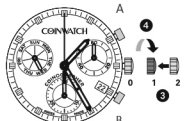

04

Adjusting the chronograph hands to zero position

Example:

One or several chronograph hands are not in their correct zero positions and have to be adjusted (e.g. following a battery change).

- 1 Pull out the crown to Position 2 (in their correct or incorrect zero position.)
- 2 Keep Push-buttons A and B depressed simultaneously for at least 2 seconds (the second counter hand rotates by 360° → corrective mode is activated.)

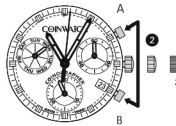
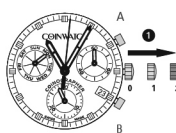

Adjusting the second counter hand

Single step A 1 x short

Continuous A long

Adjusting the next hand B

Adjusting the minute counter hand (position 6h)

Single step A 1 x short

Continuous A long

- 3 Returning the crown to Position 0

Termination of the chronograph hands adjustment (can be carried out at any time).

08